

Useful tools for installing garden edging

- Spade
- Post hole shovel
- Mattock
- Trenching shovel
- Rake
- Spirit Level
- Builders Line
- Drill
- Rubber Mallet
- Angle Grinder

STEP 1



Site preparation

- › Begin by marking out the desired line for your edging using a suitable survey marking product.
- › Use a spade and or mattock to cut away any lawn or clear any vegetation along this line.
- › Using a trenching shovel excavate a trench wide and deep enough to accommodate the edging, ensuring it will finish level with your desired height once installed. Remove any lawn, rocks or roots that will impede the installation of the edging.

! *Tip: It's better to dig the trench slightly deeper than required. Adjustments to the finished level of the edging can be made during installation. With the optional anchor post system, 250mm edging can retain at its full height. It's only necessary to bury the edging enough to provide a professional finish.*

STEP 2

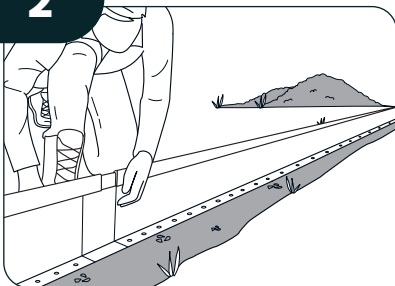

Lay the edging

- › Place 2-3 lengths of your garden edging into the trench at a time.
- › Adjust the edging as needed to create smooth curves or straight edges, depending on your design.
- › Take your time to align the edging properly for a clean finish.

STEP 3

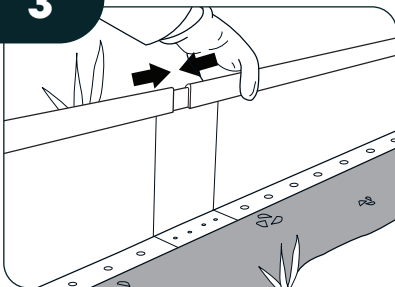

Joining

- › Where two pieces of edging meet, use joiners to connect the section securely.
- › Each edging length is supplied with a joiner piece pre-attached.
- › This will slide easily into the end of the following length and can be secured using two Tek screws in the pre-drilled holes on the foot.
- › This step is crucial for maintaining continuity and preventing unsightly gaps.

! *Tip: There are two additional predrilled holes in the top edge of the edging, these are optional fixing points for cases when the join may be under abnormal stress. If fixing through these holes is required, use a 3.2mm x 4mm rivet.*



Installation Guide for 250mm Edging

STEP 4

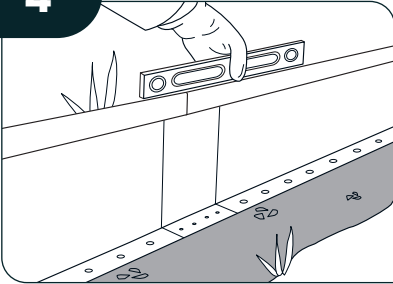

Levelling

- › For straight sections use a builder's line set at the finished height of the edging.
- › Check the top of the edging to ensure it is level and consistent along the entire length.
- › Use a spirit level for curved sections.
- › Make any final adjustments as needed for a polished, professional finish.

STEP 5

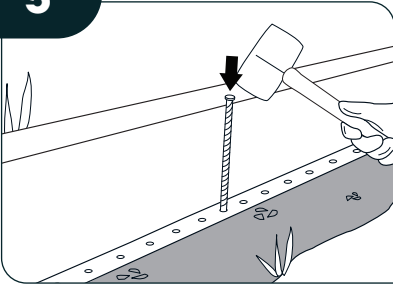

Secure with galvanised twisted nails

- › Each length of 250mm high edging is supplied with five galvanised twisted nails.
- › On every length installed, insert three of these galvanised twisted nails into the existing holes located along the edging foot to hold the section in position.
- › Ensure the galvanised twisted nails are driven firmly into the ground so the edging remains aligned during the installation process.

STEP 6

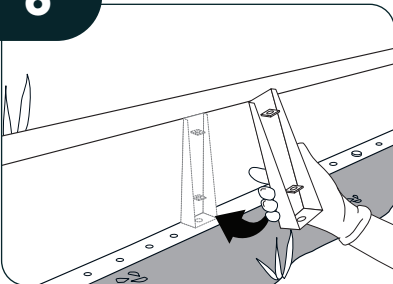

Installing braces

- › Each length of 250mm high edging is supplied with two braces.
- › Insert these braces evenly along the installed edging sections and put them in position.
- › Ensure each brace sits flat against the edging foot and is aligned correctly before anchoring.



Installation Guide for 250mm Edging

STEP 7a

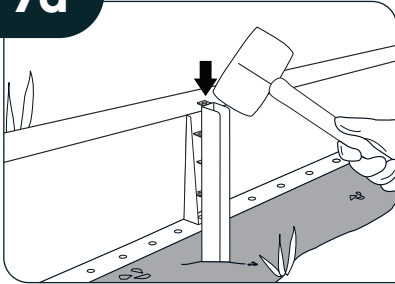

STEP 7b

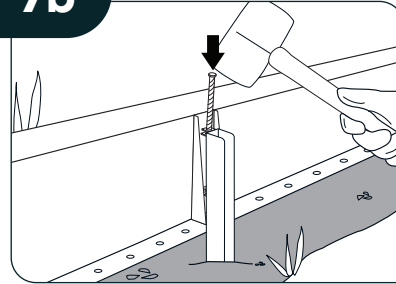

Installing the anchoring posts and securing

We recommend using 2 x 500mm long anchoring posts per edging length. Align the anchoring post with the brace, ensuring the tongues on the anchor post align with the tongues on the brace.

! *Tip: Anchors are sold separately. In cases where the edging is being used to raise the garden bed by more than 150mm it is necessary to anchor with the optional 500mm anchoring posts.*

7a: Install the anchor post:

- › Hammer the anchor post firmly into the ground behind the edging.

7b: Secure the assembly:

- › Use the remaining two galvanised twisted nails to lock the two anchor posts to the braces.
- › This connection ensures the brace, anchor post and edging form a rigid, reinforced structure.

STEP 8

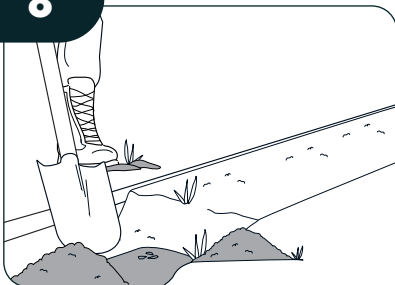

Backfilling

- › Once the edging is secure, use a rake or shovel to backfill the trench with the soil or material you initially removed.
- › Pack the soil firmly around the base of the edging to provide additional stability.
- › Fill the raised garden bed with a suitable growing medium.

! *Tip: To maximise the longevity of your edging the back should be painted with a bitumen membrane and allowed to dry before backfilling with soil.*

STEP 9

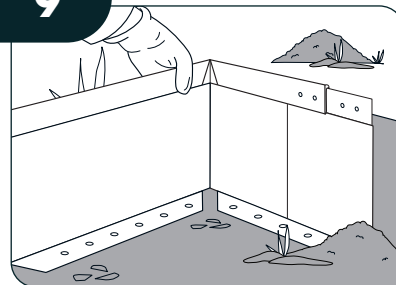

Corners

- › Optional internal and external prefabricated corners are available, they are supplied prepressed to 90 degrees. Each side of the corner is 250mm long.
- › If the need to manufacture a corner onsite is required. Use an angle grinder to cut a V in the foot and the top edge then score the fold line to make it easier to fold by hand.
- › **Please follow all safety guidelines and wear suitable PPE.**

! *Tip: Use a block of wood clamped along the fold line when folding the corner to help provide a professional finish. A rubber mallet is useful to make final adjustments to the angle of the corner.*



Installation Guide for 250mm Edging



PO Box 3024, Lesmurdie WA 6076
1300 208 861 | info@formlineedging.com
formlineedging.com